



2022-2023 Student Health Insurance Plan

University of Tampa Student Health Insurance Plan administered by
UnitedHealthcare **StudentResources**

UnitedHealthcare **StudentResources**
Presented by: Mandy Lance

22COL4431-629

United
Healthcare



Important Things To Know Your Coverage

UnitedHealthcare StudentResources

Important Things To Know

University of Tampa enrolls all students in school sponsored student health insurance plan administered by UnitedHealthcare **StudentResources**. Benefits include:

- Medical and prescription plan
- Telehealth
- StudentAssist
- Global Emergency Plan



- ✓ Once the university submits your enrollment to UHCSR you will receive an email with instructions detailing how to access your ID card and create your online account.
- ✓ It is important for you to create your online account.
- ✓ This is national coverage, not just for while you are at school.
- ✓ **Please review the policy brochure detailing all of the plan benefits at uhcsr.com/UT.**

Highlights of Coverage and Service

	Preferred Providers	Out-of-Network Providers
Overall Plan Maximum	There is no overall maximum dollar limit on the policy	
Plan Deductible	\$5,000 per Insured Person, Per Policy Year. The Deductible will not be applied until the Company has paid \$2,500 in Covered Medical Expenses.	\$10,000 per Insured Person, Per Policy Year. The Deductible will not be applied until the Company has paid \$2,500 in Covered Medical Expenses.
Out-of-Pocket Maximum <i>After the Out-of-Pocket Maximum has been satisfied, Covered Medical Expenses will be paid at 100% for the remainder of the Policy Year subject to any applicable benefit maximums. Refer to the plan brochure for details about how the Out-of-Pocket Maximum applies.</i>	\$6,350 Per Insured Person, Per Policy Year \$12,700 For all Insureds in a family, Per Policy year	There is no out of pocket maximum for out of network benefits.
Coinsurance <i>All benefits are subject to satisfaction of the Deductible, specific benefit limitations, maximums and Copays as described in the plan brochure.</i>	80% to \$ 2,500, Deductible applies after \$ 2,500, then 100% thereafter.	50% to \$2,500, Deductible applies after \$2,500, then 70% thereafter.
Prescription Drugs <i>UHCP Mail Order Network Pharmacy or Preferred 90 Day Retail Network Pharmacy at 2.5 times the retail Copay up to a 90 day supply.</i>	\$30 Copay per prescription for Tier 1 \$60 Copay per prescription for Tier 2 50% Coinsurance per prescription for Tier 3 up to a 31-day supply per prescription not subject to deductible	No Benefits

Highlights of Coverage and Service

	Preferred Providers	Out-of-Network Providers
<p>Preventive Care Services <i>Including but not limited to: annual physicals, GYN exams, routine screenings and immunizations. No Copay or Deductible when the services are received from a Preferred Provider. Please see www.healthcare.gov for complete details of the services provided for specific age and risk groups.</i></p>	100% of Allowed Amount	No Benefits
<p>The following services have per Service Copays/Deductibles <i>This list is not all inclusive. Please read the plan brochure for complete listing of Copays/Deductibles.</i></p>	<p>Physician's Visits: \$15 Copay Per Visit not subject to deductible</p> <p>Medical Emergency: \$125 after deductible The Copay will be waived if admitted to the Hospital</p>	<p>Medical Emergency: \$125 after Deductible The Copay will be Waived if admitted to the Hospital</p>
<p>UnitedHealthcare Global: Global Emergency Services</p>	<p>Domestic Students are eligible for UnitedHealthcare Global services when 100 miles or more away from your campus address and 100 miles or more away from your permanent home address. International students are covered worldwide except in their home country.</p>	
<p>Metallic Level - Gold</p>	<p>Network – UnitedHealthcare Choice Plus</p>	

*This table provides a brief summary of benefits under the plan. Exclusions and limitations may apply. Please refer to plan documents for a full description.

My Account

The screenshot shows the UnitedHealthcare StudentResources My Account dashboard. At the top, the UnitedHealthcare logo and 'StudentResources' are on the left. On the right, there are notification icons (a yellow triangle with '1' and a blue envelope with '2'), a user profile icon labeled 'Student' with 'S# ID: 9999999', and a dropdown arrow. Below this is a dark blue navigation bar with the following tabs: Home (selected), My Coverage, My Claims, My Benefits, Care Options, Messages, Action Center, and Need Assistance?. The main content area is divided into three columns. The left column is titled 'My Claims/Balances' and contains three items: 'Claims Summary' (Summary of pending & completed claims), 'Member Balances' (Deductible and Out-of-Pocket Balances), and 'Submit Claim' (Request Reimbursement for your claims). The middle column is titled 'My Benefits' and contains two items: 'Medical' (represented by a red cross icon) and 'Additional Benefits' (represented by three yellow stars). The right column is titled 'Care Options' and contains several items: 'Find Medical Provider/Estimate Cost' (Locate a Healthcare Provider), 'Find Mental Health Resources' (Review your Mental Health Services), 'Student Health Center' (Your school's Student Health Center), 'Telehealth Medical' (24/7 doctor access), 'Telehealth Mental Health' (Virtual online counseling), 'Pharmacy Locator' (Find a pharmacy nearby), and 'Not Sure Where To Go?' (Know your care options and cost). At the bottom of the Care Options column is an 'Explore More' button. Below the main content area are three rows of service tiles: 'ID Card' (Print, View, or Request ID card), '24/7 Crisis/Counseling Support' (Immediate access to a licensed clinician), 'Coverage Information' (View coverage details), 'Enroll Dependent' (Enroll dependents on your plan), 'PRA' (Appoint Personal Representative), and 'Need Assistance?' (How may we help you?).

UnitedHealthcare | StudentResources

Student
S# ID: 9999999

Home My Coverage My Claims My Benefits Care Options Messages Action Center Need Assistance?

My Claims/Balances

- Claims Summary**
Summary of pending & completed claims
- Member Balances**
Deductible and Out-of-Pocket Balances
- Submit Claim**
Request Reimbursement for your claims

My Benefits

- Medical**
- Additional Benefits**

Care Options

- Find Medical Provider/Estimate Cost**
Locate a Healthcare Provider
- Find Mental Health Resources**
Review your Mental Health Services
- Student Health Center**
Your school's Student Health Center
- Telehealth Medical**
24/7 doctor access
- Telehealth Mental Health**
Virtual online counseling
- Pharmacy Locator**
Find a pharmacy nearby
- Not Sure Where To Go?**
Know your care options and cost

[Explore More](#)

ID Card
Print, View, or Request ID card

24/7 Crisis/Counseling Support
Immediate access to a licensed clinician

Coverage Information
View coverage details

Enroll Dependent
Enroll dependents on your plan

PRA
Appoint Personal Representative

Need Assistance?
How may we help you?

Understanding Insurance

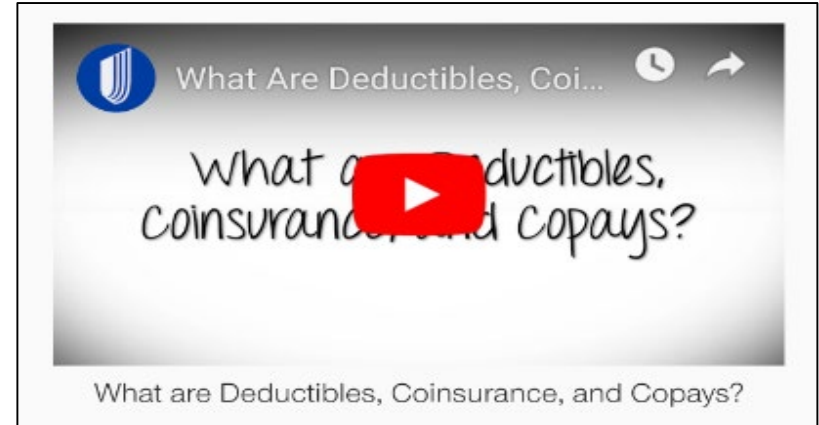

 StudentResources



FAQ



Glossary



Health Insurance 101



Video

Login to My Account 

UHCSR Mobile App

- View, Fax, or Email ID Card
- Create an Account
- View Recent Claims (60 days)
- Provider Search
- Customer Service and Claims Contact Information
- Available on Google Play and the App Store

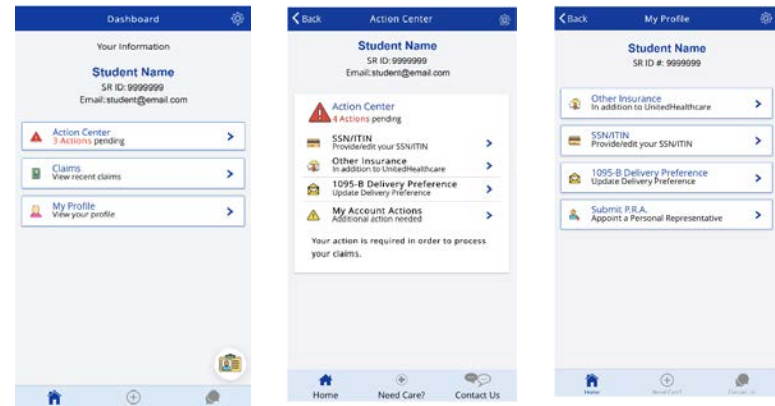



Virtual Medical and Mental Health Care

Virtual visits



We have partnered with HealthiestYou to provide access to doctors and mental healthcare from anywhere students are. All services are free for students covered under the insurance plan. Available in all 50 states.

Medical – phone or video

- 24/7 physician access
- No cost for students covered under the plan
- Reduced rate available to non-UHCSR members

Mental Health – phone or video

- Talk to a board-certified psychiatrist, licensed psychologist, therapist or counselor – the member chooses
- Schedule an appointment
- No cost for students covered under the plan
- Reduced rates for non-UHCSR members.





Thank you

